

# RoboMaster

## RL35 Red Laser Sight

User Guide

v1.2 2020.06

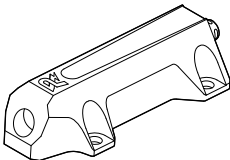

## **Disclaimer**

Thank you for purchasing the RoboMaster™ RL35 Red Laser Sight (hereinafter referred to as “Laser Sight”). Read this entire document and all safe and lawful practices DJI™ provided carefully before use. Failure to read and follow instructions and warnings may result in serious injury to yourself or others, damage to your DJI product, or damage to other objects in the vicinity. By using this product, you hereby signify that you have read this document carefully and that you understand and agree to abide by all terms and conditions of this document and all relevant documents of this product. You agree to only use this product for proper purposes. You agree that you are solely responsible for your own conduct while using this product, and for any consequences thereof. DJI accepts no liability for damage, injury, or any legal responsibility incurred directly or indirectly from the use of this product.

DJI is a trademark of SZ DJI TECHNOLOGY CO., LTD. (abbreviated as “DJI”) and its affiliated companies. Names of products, brands, etc., appearing in this document are trademarks or registered trademarks of their respective owner companies. This product and document are copyrighted by DJI with all rights reserved. No part of this product or document shall be reproduced in any form without the prior written consent or authorization of DJI.

This document and all other collateral documents are subject to change at the sole discretion of DJI. For up to date product information, visit <http://www.dji.com> and click on the product page for this product.

## **Warnings**

1. Avoid directly exposing eyes to the laser. Wear laser goggles when using the product.
2. This product is NOT a toy and is not suitable for those under the age of 18. Keep the product out of the reach of children to avoid danger caused by improper use.
3. Make sure to use the product in strict accordance with the specifications listed in this document, including those related to voltage.

## **Introduction**

The RoboMaster RL35 Red Laser Sight is an auxiliary sighting device designed for RoboMaster robots. The fixed mounting holes are suitable for modules with mounting hole

spacing dimensions of 16×30 mm (such as the speed monitor module of the robot referee system.) After successfully mounting the laser, it can emit a red dot laser with an exit pupil of 5 mm to assist with aiming. The pitch angle of the laser sight has an adjustable range of  $\pm 4.5^\circ$ .

## In the Box



x 1

Red Laser Sight



x 4

Concave Gasket



x 4

Convex Gasket



x 2

Conical Spring



x 4

Screws ( M2.5×10 )

## Installation

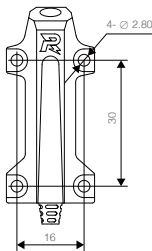

Top View

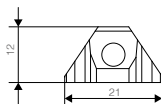

Front View

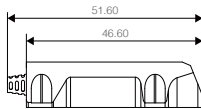

Side View

Unit: mm

1. As shown below in the illustration, mount the concave gaskets, convex gaskets, and laser sight to the fixing holes of the device in turn. Secure the mounting holes of the launching end on the laser sight with screws and threadlocker. Make sure the gaskets are mounted in the correct direction. When tightening screws, make sure that the laser sight is rotatable and also has a balanced damping ratio.
2. Place the conical spring between the mounting holes of the connection end on the laser sight and fixing holes of the device. Secure the mounting holes with screws and threadlocker. Make sure the spring is placed in the correct direction.
3. To emit the laser, connect the power cable to the laser port of the RoboMaster Development Board or any DC power port with a voltage of 5 V. Make sure the power cable is connected properly (red = positive, black = negative.)

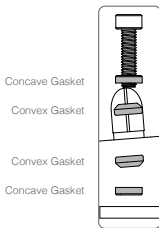

\* Note that gaskets should be mounted in the correct direction (as shown on the left.)

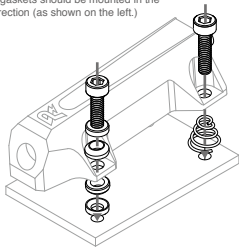

4. Adjust the pitch angle of the laser sight by tightening or loosening the screws of the connection end. When the adjustment is complete, tighten the screws of the launching end.

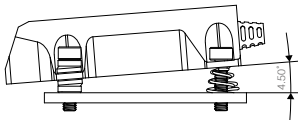

## Specifications

Model	RL35
Dimensions	51.6 × 21 × 12 mm
Output Wavelength	650 nm ± 10 nm
Output Optical Power	≤35 mW
Operating Voltage (DC)	5 V
Operating Current	80 - 100 mA
Operating Temperature	0° to 40° C (32° to 104° F)
Adjustable Angle Range	±4.5°
Laser Class	Class IIIB (IEC 60825-1:2014)
Beam Divergence	<0.05°
Length	26 cm



[WWW.ROBOMASTER.COM](http://WWW.ROBOMASTER.COM)

**R** and **ROBOMASTER** are trademarks of DJI.

Copyright © 2020 DJI All Rights Reserved.

Printed in China